



# Technical Data Sheets

## For Models:

<b><u>Model Number / Description</u></b>	<b><u>File Name</u></b>
B-2250 Floor-Standing Swing-Top Waste Receptacle	B-2250.pdf
B-2260 Floor-Standing Open-Top Waste Receptacle	B-2250.pdf
B-2280 Floor-Standing Open-Top Waste Receptacle	B-2250.pdf
B-2300 Floor-Standing Open-Top Waste Receptacle	B-2300.pdf
B-2400 Floor-Standing Large-Capacity Waste Receptacle	B-2400.pdf
B-275 Surface-Mounted Waste Receptacle	B-275.pdf
B-277 ConturaSeries® Surface-Mounted Waste Receptacle	B-277.pdf
B-279 ClassicSeries® Surface-Mounted Waste Receptacle	B-279.pdf
B-3644 ClassicSeries® Recessed Waste Receptacle	B-3644.pdf
B-43644 ConturaSeries® Waste Receptacle	B-43644.pdf
B-527 TrimlineSeries™ Waste Door	B-527.pdf
B-5277 MatrixSeries™ Surface-Mounted Waste Receptacle	B-5277.pdf
B-529 Circular Waste Chute for Countertops	B-529.pdf
B-532 Circular Waste Chute for Countertops	B-532.pdf



**Technical Data**

# FLOOR-STANDING STAINLESS STEEL WASTE RECEPTACLES

# B-2250

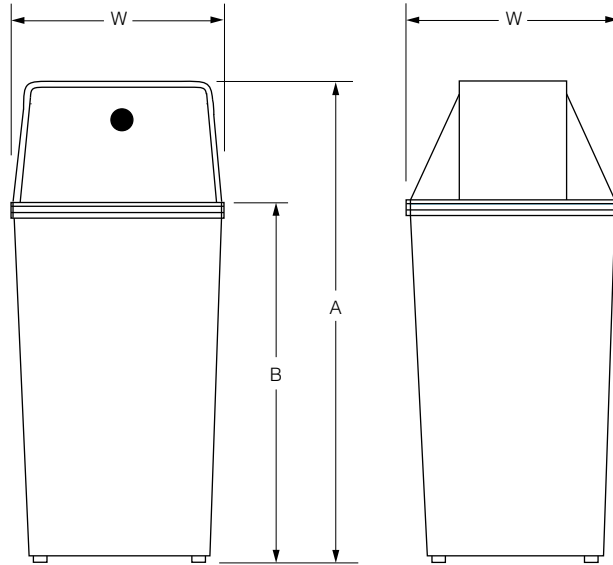

Model Number	Capacity	A	B	W	Optional Accessory Vinyl Liner Part No.
B-2250	13-gal. (49.2-L)	29-1/2" (750mm)	22" (560mm)	12-1/2" x 12-1/2" (320 x 320mm)	2250-3
B-2260	13-gal. (49.2-L)	Open-Top, No Cover	22" (560mm)	12-1/2" x 12-1/2" (320 x 320mm)	2250-3
B-2280	21-gal. (79.5-L)	Open-Top, No Cover	30" (760mm)	14" x 14" (355 x 355mm)	2270-3

### MATERIALS:

**Waste Receptacle** — 22-gauge (0.8mm) stainless steel with satin finish. Equipped with vinyl bumper strip and rubber feet. Hooks are provided to attach optional, removable liner (not provided) to upper interior corners.

**Cover** — 22-gauge (0.8mm) stainless steel with satin finish. Two spring-loaded, self-closing doors, which have an international graphic symbol to identify waste disposal, are secured with full-length, stainless steel piano-hinges.

### OPERATION:

Entire cover is removable for easy servicing of receptacle. Vinyl bumper strip and rubber feet on waste receptacle protect wall and floor surfaces.

*Designer's Note:* Vinyl liners for waste receptacle are available from Bobrick as an accessory. Check the chart above for correct liner part number to order.

### SPECIFICATION:

Waste receptacle shall be 22-gauge (0.8mm) stainless steel. Exposed surfaces shall have satin finish. Waste receptacle shall be equipped with vinyl bumper strip and rubber feet. Capacity shall be \_\_\_\_\_ (insert capacity). Manufacturer's service and parts manual shall be provided to the building owner/manager upon request.

**Waste Receptacle shall be Model \_\_\_\_\_ (insert model number) of Bobrick Washroom Equipment, Inc. Clifton Park, New York; Jackson, Tennessee; Los Angeles, California; Bobrick Washroom Equipment Company, Scarborough, Ontario; Bobrick Washroom Equipment Pty. Ltd., Australia; and Bobrick Washroom Equipment Limited, United Kingdom.**



## Technical Data

# FLOOR-STANDING DOME-LID WASTE RECEPTACLE

# B-2300

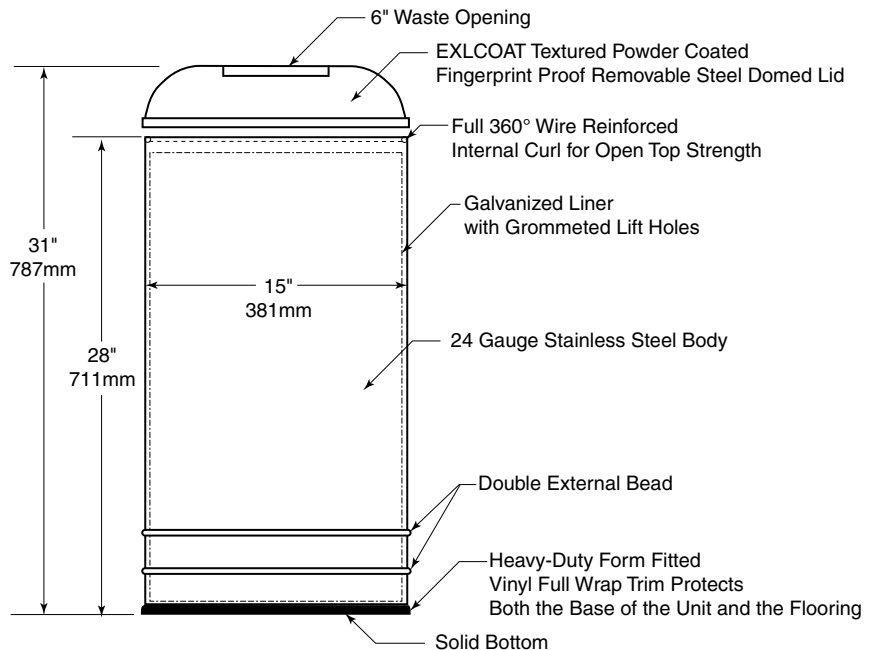

### MATERIALS:

**Waste Receptacle** — Floor-standing cylinder with solid bottom. Exposed surface has satin-finish.

**Dome-Lid** — Black powder coated steel 15" (381mm) diameter, 22 gauge (0.8mm) with 6" (150mm) diameter opening.

**Waste Container** — Galvanized steel with grommated lift holes. Removable for servicing. Capacity: 18-gal. (68.1-L).

### OPERATION:

Dome lid lifts off waste receptacle for servicing. Wide opening provides hygienic, no-touch waste disposal.

*Designer's Note:* This unit is not suitable for outside use.

### SPECIFICATION:

Floor-standing waste receptacle shall be stainless steel with satin-finish. Waste receptacle shall have a solid bottom with a heavy-duty form fitted vinyl full wrap trim, a double external bead and a removable black steel dome-lid. Dome-lid shall have a 6" (150mm) diameter opening. Unit shall be furnished with a removable, galvanized-steel waste container that has a capacity of 18-gal. (68.1-L). Manufacturer's service and parts manual shall be provided to the building owner/manager upon request.

**Floor-Standing Dome-Lid Waste Receptacle shall be Model B-2300 of Bobrick Washroom Equipment, Inc., Clifton Park, New York; Jackson, Tennessee; Los Angeles, California; Bobrick Washroom Equipment Company, Scarborough, Ontario; Bobrick Washroom Equipment Pty. Ltd., Australia; and Bobrick Washroom Equipment Limited, United Kingdom.**



## Technical Data

# FLOOR-STANDING LARGE-CAPACITY WASTE RECEPTACLE

# B-2400

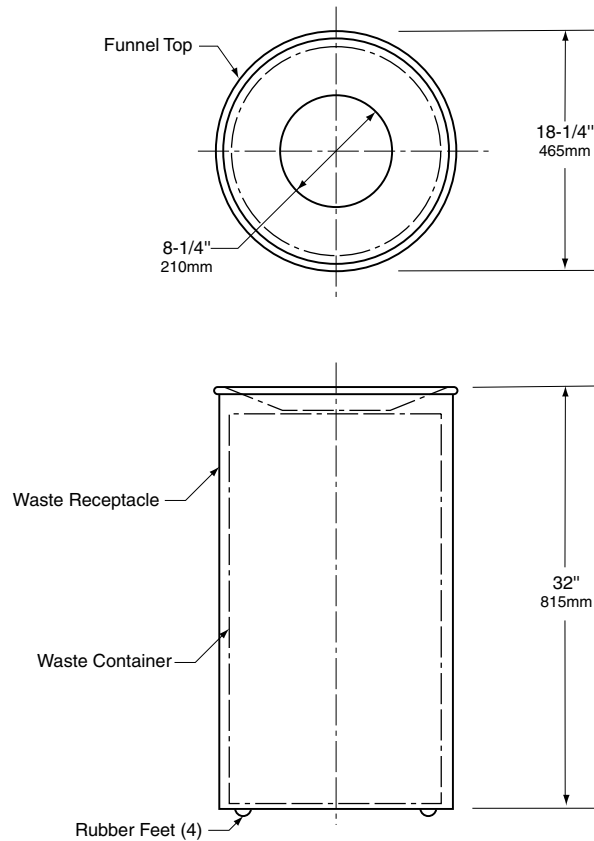

### MATERIALS:

**Waste Receptacle** — 18-8 S, type-304, 16-gauge (1.6mm) stainless steel with satin finish. All-welded construction. 1/2" (13mm) recessed bottom equipped with four 1-1/2" (40mm) diameter x 3/4" (19mm) high, heavy-duty rubber feet.

**Funnel Top** — 18-8 S, type-304, 16-gauge (1.6mm) stainless steel with satin finish. One-piece construction. 8-1/4" (210mm) diameter opening.

**Waste Container** — Galvanized steel with wire handle. Removable for servicing. Capacity: 33-gal. (125-L).

### OPERATION:

Funnel top lifts off for removal and servicing of waste container. Wide opening provides hygienic, no-touch waste disposal. Heavy-duty rubber feet protect flooring and elevate receptacle slightly off the floor.

*Designer's Note:* This unit is not suitable for outside use.

### SPECIFICATION:

Floor-standing waste receptacle shall be type-304, 16-gauge (1.6mm) stainless steel with satin finish. One-piece funnel top shall have 8-1/4" (210mm) diameter opening. Bottom of receptacle shall be recessed 1/2" (13mm) and equipped with four heavy-duty rubber feet that elevate receptacle slightly off floor. Removable, galvanized-steel waste container shall have a wire handle and a minimum capacity of 33-gal. (125-L).

**Floor-Standing Waste Receptacle shall be Model B-2400 of Bobrick Washroom Equipment, Inc., Clifton Park, New York; Jackson, Tennessee; Los Angeles, California; Bobrick Washroom Equipment Company, Scarborough, Ontario; Bobrick Washroom Pty, Ltd., Australia; and Bobrick Washroom Limited, United Kingdom.**



# Technical Data

# SURFACE-MOUNTED WASTE RECEPTACLE

# B-275

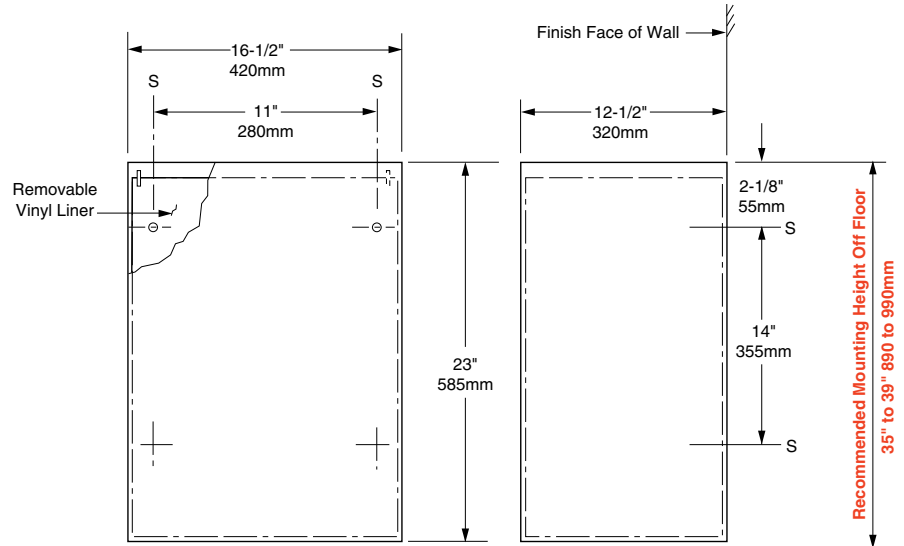

### MATERIALS:

**Receptacle** — 18-8 S, type-304, 22-gauge (0.8mm) stainless steel with satin finish. Bottom edges are hemmed. Equipped with four spot-welded interior hooks for attaching the vinyl liner. Stainless steel straps on back of unit reinforce the four mounting screw holes. Capacity: 20-gal. (75.7-L).

**Liner** — Heavy-gauge vinyl with four grommets. Removable for servicing.

### OPERATION:

Removable vinyl liner attaches to four interior hooks of waste receptacle. Bottom edges are hemmed for maximum safety. Space between bottom of receptacle and floor when unit is mounted on wall facilitates floor cleaning.

### INSTALLATION:

Mount unit to wall with four sheet-metal screws furnished by manufacturer at points indicated by an S. For plaster or dry wall construction, provide concealed backing to comply with local building codes and secure with screws furnished. For other wall surfaces, provide fiber plugs or expansion shields for use with sheet-metal screws furnished, or provide 1/8" (3mm) toggle bolts or expansion bolts.

### SPECIFICATION:

Surface-mounted waste receptacle shall be type-304, 22-gauge (0.8mm) stainless steel. Exposed surfaces shall have satin finish. Waste receptacle shall be equipped with four interior hooks, have reinforced mounting screw holes, and shall be furnished with a removable heavy-gauge vinyl liner. Unit shall have a capacity of 20-gal. (75.7-L). Manufacturer's service and parts manual shall be provided to the building owner/manager upon request.

**Surface-Mounted Waste Receptacle shall be Model B-275 of Bobrick Washroom Equipment, Inc., Clifton Park, New York; Jackson, Tennessee; Los Angeles, California; Bobrick Washroom Equipment Company, Scarborough, Ontario; Bobrick Washroom Equipment Pty. Ltd., Australia; and Bobrick Washroom Equipment Limited, United Kingdom.**



## Technical Data

# ConturaSeries® SURFACE-MOUNTED WASTE RECEPTACLE with LinerMate™

# B-277



Patented

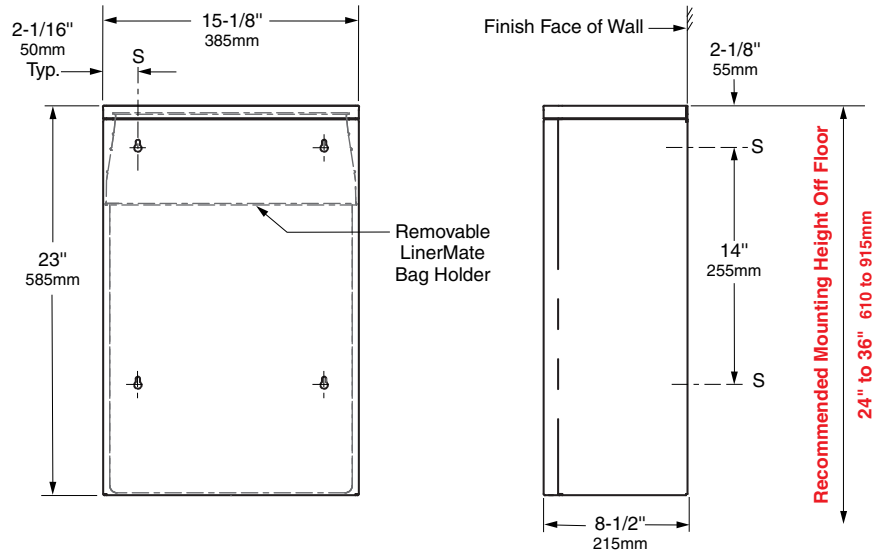

### MATERIALS:

**Receptacle** — 18-8 S, type-304, 20-gauge (0.91mm) stainless steel. All-welded construction. Exposed surfaces have satin finish. Front of waste receptacle has same degree of arc as other Bobrick ConturaSeries washroom accessories. Radius on side edges of waste receptacle complement other ConturaSeries accessories. Top edge hemmed and bottom has recessed finger grip. Stainless steel reinforcement straps on back of unit provide strength to the four mounting screw holes. Capacity: 12.75-gal. (48.3-L).

**LinerMate™ Trash Liner Holder** — Molded plastic sleeve and U-shaped 18-8 S, type-304, 20-gauge (0.91mm) stainless steel support strap hemmed for safety; riveted construction. LinerMate rests inside of waste receptacle area. Removable for servicing.

### OPERATION:

Top edge of waste receptacle is hemmed and bottom has a recessed finger grip for safe handling. The space between bottom of waste receptacle and the floor when unit is properly mounted facilitates floor cleaning. Unit is equipped with LinerMate to accommodate disposable trash liners. LinerMate eliminates unsightly trash liner overhang and facilitates installation and removal of disposable trash liners.

To insert disposable trash liner, lift LinerMate up and forward and rest over edge of waste receptacle front panel with the bottom notches of LinerMate engaged on top front edge of receptacle. Place disposable trash liner inside LinerMate and fold disposable trash liner over LinerMate sleeve. Tie a knot in the corner of the bag, then place LinerMate with disposable trash liner back into receptacle. To empty, gather disposable trash liner from LinerMate sleeve and lift bag up.

### INSTALLATION:

Mount unit on wall with four sheet-metal screws (not furnished) at points indicated by an S. For plaster or dry wall construction, provide concealed backing to comply with local building codes and secure with sheet-metal screws. For other wall surfaces, provide fiber plugs or expansion shields for use with sheet-metal screws, or provide 1/8" (3mm) toggle bolts or expansion bolts.

### SPECIFICATION:

Surface-mounted waste receptacle shall be type-304 stainless steel with all-welded construction; exposed surfaces shall have satin finish. Front of waste receptacle shall have same degree of arc and match other Bobrick ConturaSeries accessories in the washroom. Radius on side edges of waste receptacle shall complement other Bobrick ConturaSeries washroom accessories. Top edge shall be hemmed and bottom of waste receptacle shall have recessed finger grip for safe handling. Waste receptacle shall be equipped with LinerMate to facilitate installation and removal of disposable trash liners without unsightly overhang. LinerMate shall have a molded plastic sleeve with a 20-gauge (0.91mm) stainless steel, U-shaped support strap hemmed for safety; riveted construction. LinerMate shall rest inside of waste receptacle area. Capacity shall be 12.75-gal. (48.3-L).

**Surface-Mounted Waste Receptacle shall be Model B-277 of Bobrick Washroom Equipment, Inc., Clifton Park, New York; Jackson, Tennessee; Los Angeles, California; Bobrick Washroom Equipment Company, Scarborough, Ontario; Bobrick Washroom Equipment Pty. Ltd., Australia; and Bobrick Washroom Equipment Limited, United Kingdom.**



Technical Data

# SURFACE-MOUNTED WASTE RECEPTACLE

# B-279

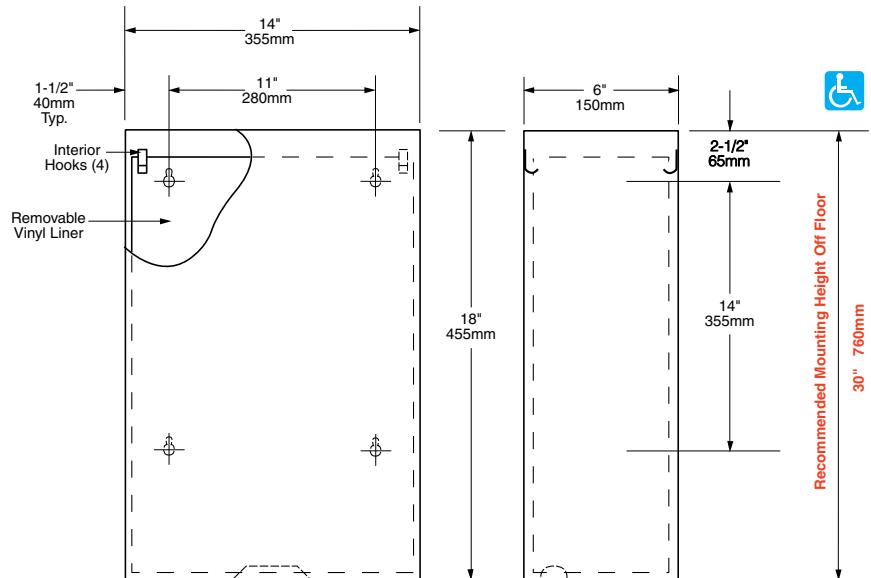

## MATERIALS:

**Receptacle** — 18-8 S, type-304 stainless steel with satin finish. Front and sides are one-piece, 22 gauge (0.8mm); back and bottom are one-piece, 26 gauge (0.5mm). All-welded construction. Top edge hemmed and bottom has recessed finger grip for safe handling. Equipped with four spot-welded interior hooks for attaching the vinyl liner. Capacity: 6.4-gal. (24.2-L).

**Liner** — Heavy-gauge vinyl with four grommets. Removable for servicing.

## OPERATION:

Removable vinyl liner attaches to four interior hooks of waste receptacle. Space between bottom of receptacle and floor, when unit is properly mounted on wall, facilitates floor cleaning.

## INSTALLATION:

Mount unit on wall with four sheet-metal screws (not furnished) at points indicated by an S. For plaster or dry wall construction, provide concealed backing to comply with local building codes, then secure unit with sheet-metal screws. For other wall surfaces, provide fiber plugs or expansion shields for use with sheet-metal screws, or provide 1/8" (3mm) toggle bolts or expansion bolts.

## SPECIFICATION:

Surface-mounted waste receptacle shall be type-304 stainless steel with all-welded construction; exposed surfaces shall have satin finish. Front and sides of waste receptacle shall be one-piece, 22 gauge (0.8mm); back and bottom shall be one-piece, 26 gauge (0.5mm). Top edge shall be hemmed and bottom of waste receptacle shall have recessed finger grip. Waste receptacle shall be equipped with four interior hooks, furnished with a removable heavy-gauge vinyl liner, and shall have a minimum capacity of 6.4-gal. (24.2-L). Manufacturer's service and parts manual shall be provided to the building owner/manager upon request.

**Surface-Mounted Waste Receptacle shall be Model B-279 of Bobrick Washroom Equipment, Inc., Clifton Park, New York; Jackson, Tennessee; Los Angeles, California; Bobrick Washroom Equipment Company, Scarborough, Ontario; Bobrick Washroom Equipment Pty. Ltd., Australia; and Bobrick Washroom Equipment Limited, United Kingdom.**



## Technical Data

# RECESSED WASTE RECEPTACLE FOR 4" (102mm) WALLS

# B-3644

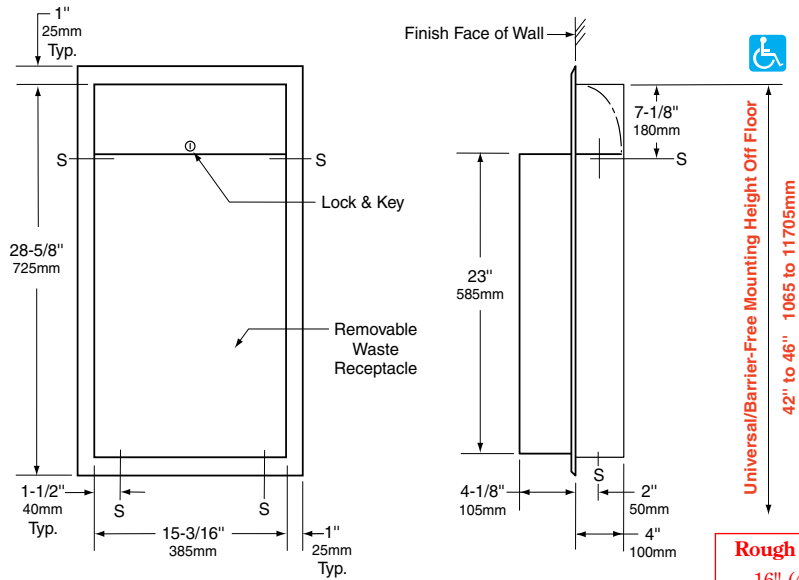

**Rough Wall Opening**  
 16" (405mm) wide  
 29-1/4" (745mm) high  
 4" (102mm) minimum  
 recessed depth

### MATERIALS:

**Cabinet** — 18-8 S, type-304, heavy-gauge stainless steel. All-welded construction. Exposed surfaces have satin finish.

**Flange** — 18-8 S, type-304, 22-gauge (0.8mm) stainless steel with satin finish. Drawn and beveled, one-piece, seamless construction.

**Waste Receptacle** — 18-8 S, type-304, 22-gauge (0.8mm) stainless steel with satin finish. Front and side edges of bottom and all top edges are hemmed for safe handling. Secured to cabinet with a tumbler lock keyed like other Bobrick washroom accessories. Equipped with interior hooks for optional vinyl liner. Capacity: 12-gal. (45.4-L).

### OPERATION:

To empty waste receptacle, unlock with key provided. Liner cannot be removed unless waste receptacle is unlocked from cabinet. Reusable vinyl liners are available as an optional accessory: order Bobrick Part No. 3944-12.

After unit is in use, if greater capacity waste receptacle is needed, an 18-gal. (68.1-L) capacity waste container can be substituted; order Bobrick Part No. 368-60 Waste Receptacle and Part No. 368-16 Vinyl Liner.

### INSTALLATION:

Provide framed rough wall opening 16" wide x 29-1/4" high (405 x 745mm). Minimum recessed depth required to finish face of wall is 4" (102mm). Allow clearance for construction features that may protrude into rough wall opening from opposite wall. Coordinate with mechanical engineer to avoid pipes, vents, and conduits. If unit projects above top of wainscot, provide aluminum channel or other filler to eliminate gap between flange and finish face of wall. Mount unit in wall opening with shims between framing and cabinet at all points indicated by an S, then secure unit with sheet-metal screws (not furnished).

### SPECIFICATION:

Recessed waste receptacle shall be type-304 stainless steel with all-welded construction; exposed surfaces shall have satin finish. Flange shall be drawn and beveled, one-piece, seamless construction. Removable waste receptacle shall be secured to cabinet with a tumbler lock keyed like other Bobrick washroom accessories, have front and side edges of bottom and all top edges hemmed for safe handling, and shall have a minimum capacity of 12-gal. (45.4-L). Manufacturer's service and parts manual shall be provided to the building owner/manager upon request.

**Recessed Waste Receptacle shall be Model B-3644 of Bobrick Washroom Equipment, Inc., Clifton Park, New York; Jackson, Tennessee; Los Angeles, California; Bobrick Washroom Equipment Company, Scarborough, Ontario; Bobrick Washroom Equipment Pty. Ltd., Australia; and Bobrick Washroom Equipment Limited, United Kingdom.**



# Technical Data

# ConturaSeries® RECESSED WASTE RECEPTACLE

# B-43644



Patented

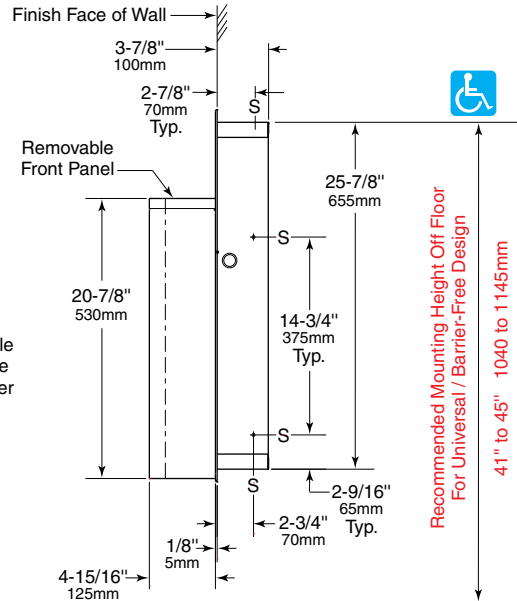
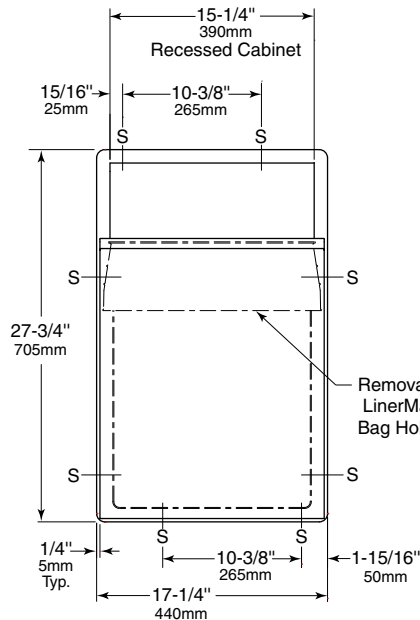

**Rough Wall Opening**  
 15-7/8" (405mm) wide  
 26-1/4" (665mm) high  
 4" (100mm) minimum  
 recessed depth

### MATERIALS:

**Cabinet** — 18-8 S, type-304, 22-gauge (0.8mm) stainless steel. All-welded construction. Exposed surfaces have satin-finish.

**Flange** — 18-8 S, type-304, 22-gauge (0.8mm) stainless steel with satin-finish. Drawn, one-piece, seamless construction. Radius on corners and return edges complement side edges of waste receptacle.

**Waste Receptacle** — 18-8 S, type-304, 22-gauge (0.8mm) stainless steel with satin-finish. Formed, one-piece, seamless construction. Removable front panel has same degree of arc as other Bobrick ConturaSeries washroom accessories. Top edge hemmed for safe handling. Radius on side edges of waste receptacle complement other ConturaSeries accessories. Secured to cabinet with two keyholes over studs on bottom and two tamper-resistant setscrews on top. Capacity: 12.8-gal. (48.3-L).

**LinerMate™ Bag Holder** — Molded plastic bag holder sleeve and U-shaped 18-8 S, type-304, 20-gauge (0.91mm) stainless steel support strap; riveted construction. Molded plastic bag holder has arc at front and same shape as inside of waste receptacle area. Removable for servicing.

### OPERATION:

To insert disposable plastic trash bag, lift LinerMate bag holder up and forward and rest over edge of waste receptacle front panel with the bottom notches of LinerMate engaged on top front edge of receptacle. Place plastic trash bag inside LinerMate and fold plastic bag over LinerMate sleeve. Tie a knot in the corner of the bag, then place LinerMate with plastic trash bag back into receptacle. To empty, gather disposable plastic trash bag from LinerMate bag holder sleeve and lift bag up. Front of waste receptacle panel is removable for cleaning cabinet interior.

### INSTALLATION:

Provide framed rough wall opening 15-7/8" wide x 26-1/4" high (405 x 665mm). Minimum recessed depth required to finish face of wall is 4" (100mm). Allow clearance for construction features that may protrude into rough wall opening from opposite wall. Coordinate with mechanical engineer to avoid pipes, vents, and conduits. If unit projects above top of wainscot, provide aluminum channel or other filler to eliminate gap between flange and finish face of wall. Mount unit in wall opening with shims between framing and cabinet at all points indicated by an S, then secure unit with #8 x 1-1/4" (4.2 x 32mm) screws (not furnished).

continued . . .

**SPECIFICATION:**

Recessed waste receptacle shall be type-304 stainless steel with all-welded construction; exposed surfaces shall have satin-finish. Front of waste receptacle shall have same degree of arc and match other Bobrick ConturaSeries accessories in the washroom. Radius on corners and edges of flange and waste receptacle shall complement other Bobrick ConturaSeries washroom accessories. Flange shall be drawn, one-piece, seamless construction. Waste receptacle shall have a formed, one-piece, seamless, removable front panel with top edge hemmed. LinerMate bag holder shall have a molded plastic bag holder sleeve with a 20-gauge (0.91mm) stainless steel, U-shaped support strap; riveted construction. Bag holder shall have an arc at front and same shape as inside of waste receptacle area. Capacity of waste receptacle shall be 12.8-gal. (48.3-L).

**Recessed Waste Receptacle shall be Model B-43644 of Bobrick Washroom Equipment, Inc., Clifton Park, New York; Jackson, Tennessee; Los Angeles, California; Bobrick Washroom Equipment Company, Scarborough, Ontario; Bobrick Washroom Equipment Pty. Ltd., Australia; and Bobrick Washroom Equipment Limited, United Kingdom.**



Technical Data

# WASTE-DISPOSAL DOOR FOR MOUNTING IN COUNTERTOPS

# B-527

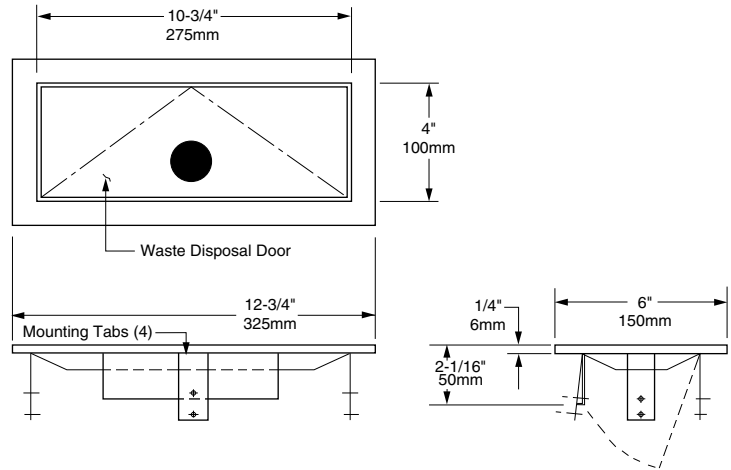

**Rough Countertop Cutout**  
 11-1/4" (285mm) wide  
 4-1/2" (115mm) high  
 3/4" to 1-1/2" (19 to 38mm) mounting thickness  
 4-1/2" (115mm) minimum clearance below mounting surface

### MATERIALS:

**Flange** — 18-8 S, type-304, 22-gauge (0.8mm) stainless steel. 1/4" (6mm) 90° return for maximum rigidity.

**Waste-Disposal Door** — 18-8 S, type-304, 22-gauge (0.8mm) stainless steel. All-welded construction. Self-closing door is equipped with a spring-loaded, full-length stainless steel piano-hinge. International graphic symbol identifies unit.

### OPERATION:

Self-closing door allows convenient disposal of paper towels and waste from the top by pushing downward through the hinged opening, then shuts tightly after use.

*Designer's Notes:* Waste receptacle is not included with unit. Housing below countertop to conceal waste receptacle is not included with the unit—must be furnished by others. Waste-disposal door may be mounted in vertical surfaces of countertop also, including aprons, skirts, or front of cabinets.

### INSTALLATION:

Unit is designed for installation in countertop. 4-1/2" (114mm) minimum clearance below mounting surface is required. Mount unit through a cutout specially ordered from countertop manufacturer or field cut. Dimensions of cutout are to be 11-1/4" wide x 4-1/2" high (285 x 115mm). Adjustable mounting tabs accommodate mounting thicknesses from 3/4" to 1-1/2" (19 to 38mm). For complete installation instructions, see Form No. 527-69, packed with each shipment; also available in advance on request.

### SPECIFICATION:

Waste-disposal door for mounting in countertops shall be type-304 stainless steel with all-welded construction; exposed surfaces shall have satin finish. Flange shall have 1/4" (6mm) 90° return. Self-closing door shall be equipped with a spring-loaded, full-length stainless steel piano-hinge and an international graphic symbol. Manufacturer's service and parts manual shall be provided to the building owner/manager upon request.

**Countertop-Mounted Waste-Disposal Door shall be Model B-527 of Bobrick Washroom Equipment, Inc., Clifton Park, New York; Jackson, Tennessee; Los Angeles, California; Bobrick Washroom Equipment Company, Scarborough, Ontario; Bobrick Washroom Equipment Pty. Ltd., Australia; and Bobrick Washroom Equipment Limited, United Kingdom.**



## Technical Data

# MatrixSeries™ SURFACE-MOUNTED WASTE RECEPTACLE

# B-5277



Patented

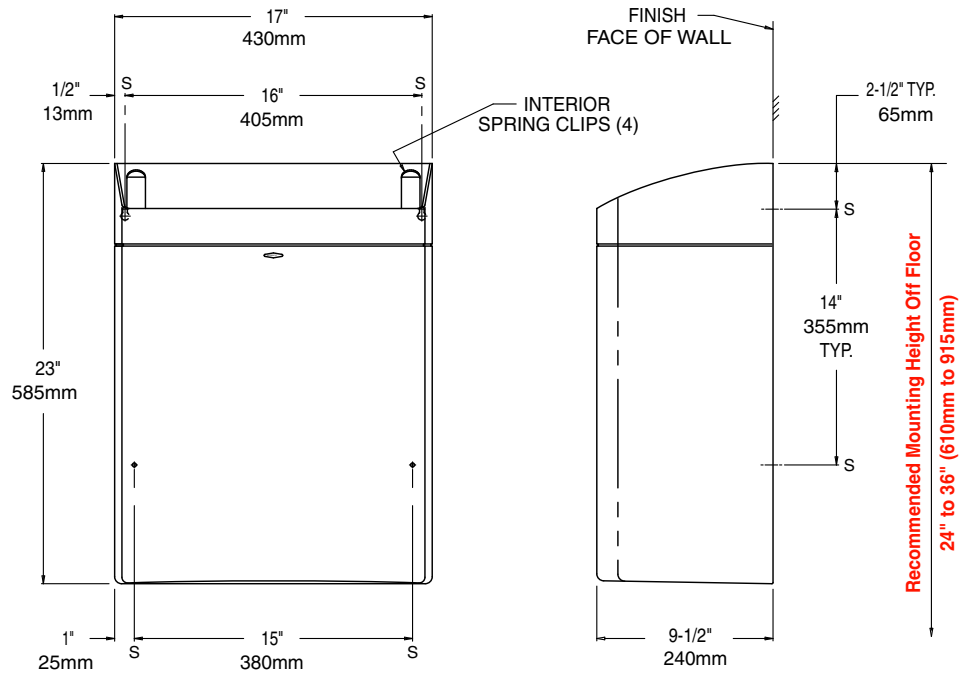

### MATERIALS:

Durable, impact-resistant grey polymer with high gloss finish on exposed surfaces. Front of waste receptacle has same degree of arc as other Bobrick MatrixSeries washroom accessories. Radius on edges and top of waste receptacle complement other MatrixSeries accessories. Equipped with four mounting screw holes and four liner clips for securing optional vinyl liner. Capacity: 13-gal. (49.2-L).

### OPERATION:

Top edge has radius for safe handling. The space between bottom of waste receptacle and the floor when unit is properly mounted facilitates floor cleaning. For Liner Clip Replacement Kit (set of 2 clips), order Bobrick Part No. 5277-13. Reusable Heavy-Gauge Vinyl Liner is available as an optional accessory: order Bobrick Part No. 5277-12

### INSTALLATION:

Mount unit on wall with four sheet-metal screws (not furnished) at points indicated by an S. For plaster or dry wall construction, provide concealed backing to comply with local building codes, then secure unit with sheet-metal screws. For other wall surfaces, provide fiber plugs or expansion shields for use with sheet-metal screws, or provide 1/8" (3mm) toggle bolts or expansion bolts.

*To Mount on Tile Wall:* Clean tile wall surface. Use double-sided roll tape, 4" wide x 42-1/2" long x 1/8" thick (100 x 1080 x 3mm) (not furnished by manufacturer). Apply 2 strips of tape vertically to back of receptacle, flush with bottom of receptacle. Stick receptacle to wall and let it set for 24 hours before use.

### SPECIFICATION:

Surface-mounted waste receptacle shall be durable, impact-resistant grey polymer with high-gloss finish on exposed surfaces. Front of waste receptacle shall have same degree of arc as other Bobrick MatrixSeries™ accessories in the washroom. Radius on edges and top of waste receptacle shall complement other Bobrick MatrixSeries™ washroom accessories. Top edge shall have radius for safe handling. Waste receptacle shall be equipped with interior clips for securing optional vinyl liner and shall have four mounting screw holes. Unit shall have a minimum capacity of 13-gal. (49.2-L). Manufacturer's service and parts manual shall be provided to the building owner/manager upon request.

**Surface-Mounted Waste Receptacle shall be Model B-5277 of Bobrick Washroom Equipment, Inc., Clifton Park, New York; Jackson, Tennessee; Los Angeles, California; Bobrick Washroom Equipment Company, Scarborough, Ontario; Bobrick Washroom Equipment Pty. Ltd., Australia; and Bobrick Washroom Equipment Limited, United Kingdom.**



**Technical Data**

# CIRCULAR WASTE CHUTE FOR MOUNTING IN COUNTERTOPS

# B-529

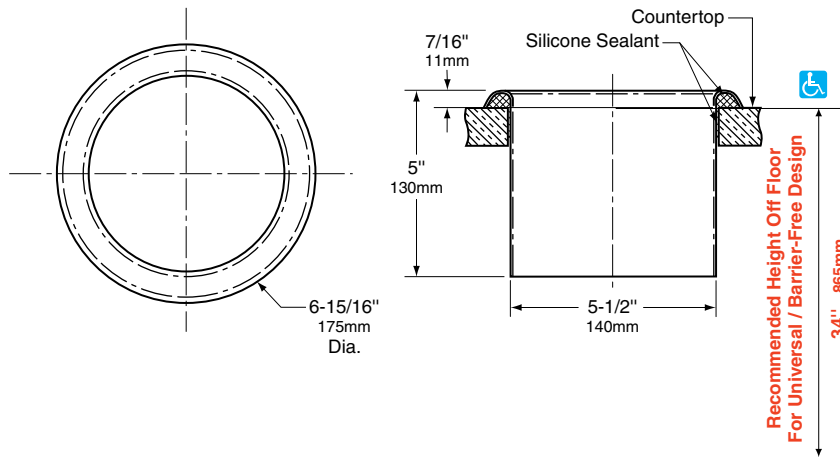

**Rough Countertop Opening**  
 $5\text{-}5/8" \pm 1/16"$  ( $140 \pm 1.5\text{mm}$ )

### MATERIALS:

**Circular Waste Chute** — Type-300, 24-gauge (0.6mm) stainless steel. Exposed surfaces have bright polished finish.

### INSTALLATION:

Unit is designed for installation in  $5\text{-}5/8" \pm 1/16"$  ( $140 \pm 1.5\text{mm}$ ) diameter hole in any countertop. To install unit permanently in place, cut hole in countertop. Fill in underside of waste chute lip and around portion of waste chute body which protrudes down into mounting hole with silicone sealant (not furnished). Install unit into countertop hole. Once unit is in place, wipe off any excess glue with a clean rag.

### SPECIFICATION:

Circular waste chute for mounting in countertops shall be type-300 stainless steel with  $5\text{-}7/16"$  (135mm) inside diameter, rolled lip and bright polished finish on exposed surfaces. Waste chute opening shall provide access to deposit waste into waste receptacle (not furnished) placed under the countertop. Manufacturer's service and parts manual shall be provided to the building owner/manager upon request.

**Circular Waste Chute For Mounting In Countertops shall be Model B-529 of Bobrick Washroom Equipment, Inc., Clifton Park, New York; Jackson, Tennessee; Los Angeles, California; Bobrick Washroom Equipment Company, Scarborough Ontario; Bobrick Washroom Equipment Pty. Ltd., Australia; and Bobrick Washroom Equipment Limited, United Kingdom.**



Technical Data

# CIRCULAR WASTE CHUTE FOR MOUNTING IN COUNTERTOPS

# B-532

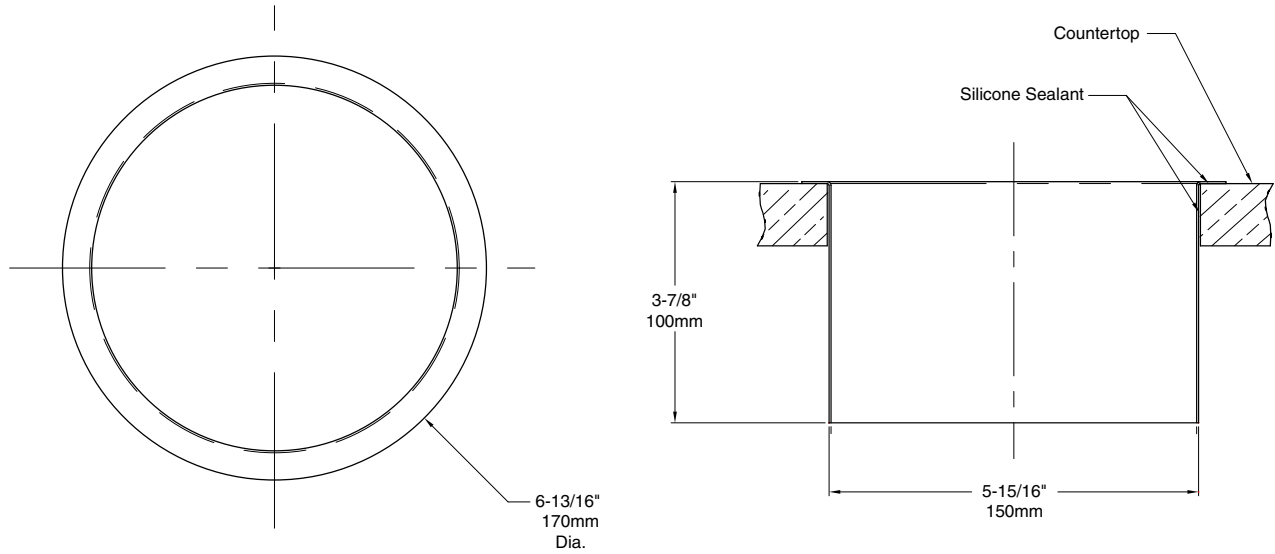

**Rough Countertop Opening**  
6-1/8" ± 1/16" (155 ± 1.5mm)

### MATERIALS:

**Circular Waste Chute** — Type-300, 22-gauge (0.8mm) stainless steel. Exposed surfaces have satin finish.

### INSTALLATION:

Unit is designed for installation in 6-1/8" ± 1/16" (155 ± 1.5mm) diameter hole in any countertop. To install unit permanently in place, cut hole in countertop. Fill in underside of waste chute lip and around portion of waste chute body which protrudes down into mounting hole with silicone sealant (not furnished). Install unit into countertop hole. Once unit is in place, wipe off any excess glue with a clean rag.

### SPECIFICATION:

Circular waste chute for mounting in countertops shall be type-300 stainless steel with 5-7/8" (150mm) inside diameter, flat lip and satin finish on exposed surfaces. Waste chute opening shall provide access to deposit waste into waste receptacle (not furnished) placed under the countertop. Manufacturer's service and parts manual shall be provided to the building owner/manager upon request.

**Circular Waste Chute For Mounting In Countertops shall be Model B-532 of Bobrick Washroom Equipment, Inc., Clifton Park, New York; Jackson, Tennessee; Los Angeles, California; Bobrick Washroom Equipment Company, Scarborough Ontario; Bobrick Washroom Equipment Pty. Ltd., Australia; and Bobrick Washroom Equipment Limited, United Kingdom.**